

THE BUILDING
IS ABOUT TO
COLLAPSE.

*HOW DO I
EVACUATE MY
FIREFIGHTERS?*



GRACE INDUSTRIES
HAS THE SOLUTION . . .

EVACUATE YOUR FIREFIGHTERS WITH **TPASS 3 EVACUATE™** SYSTEM

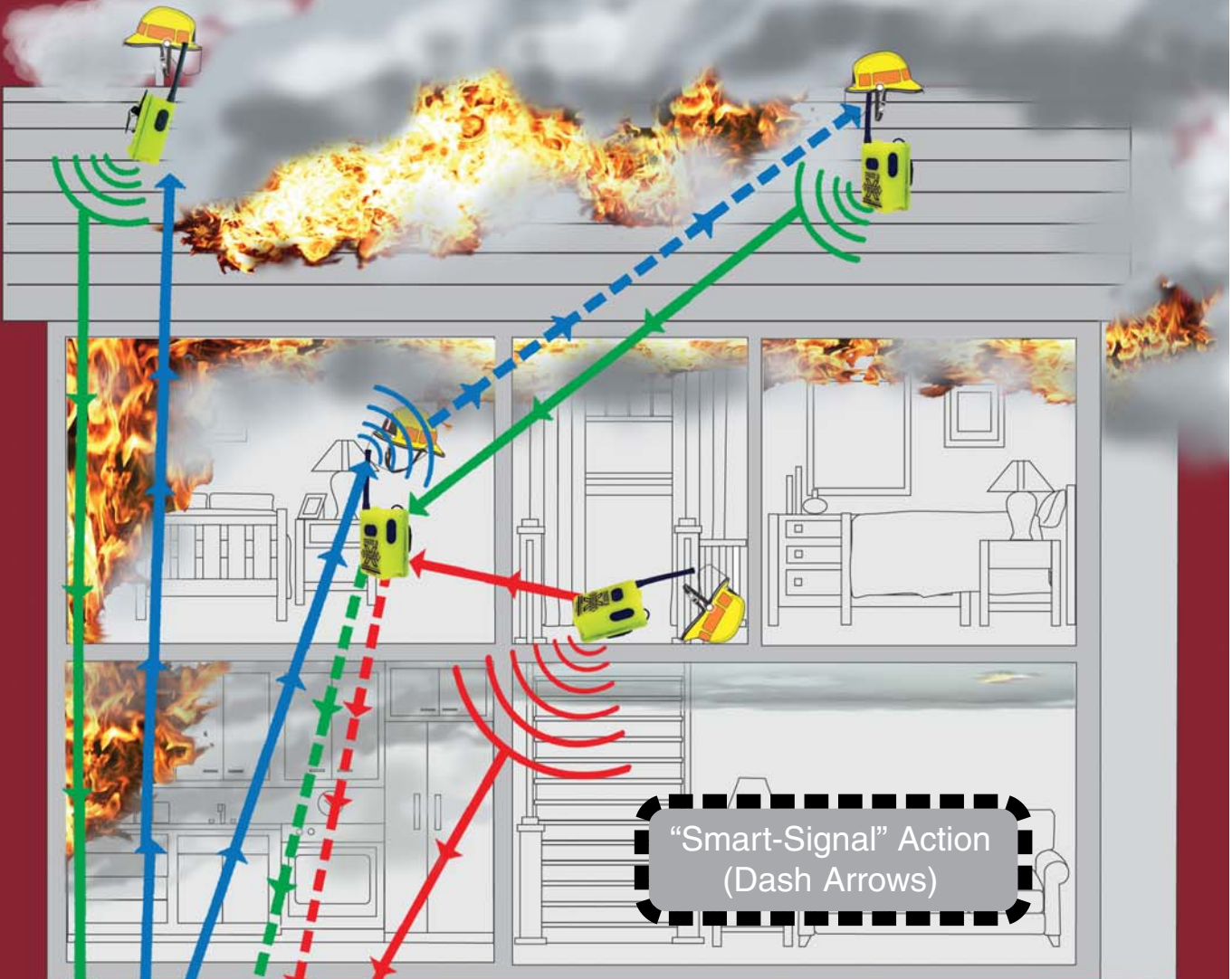

COMMAND BASE LCD T3

EVACUATE FIREFIGHTERS FROM ROOF (Solid Blue Arrows)

EVACUATE Acknowledgements From Both Firefighters (Solid Green Arrows)

Firefighter Down! Transmits Alarm Signal. (Solid Red Arrow) Firefighter's Name Comes To Top Of The List.

TPASS 3 EVACUATE™ SYSTEM A New Level of Firefighter Safety!



Firefighter shown wearing a 2-Way TPASS-3 Evacuate along with his SCBA



Incident Commander at the Command Base LCD-T3 monitoring the Firefighters status.

The only two-way PASS system that transmits Alarms and receives Evacuate signals. An Incident Commander knows who is on scene and their safety status.

They can elect to EVACUATE with unprecedented control by selecting:

- ◆ Individual Firefighters
- ◆ Groups of Firefighters
- ◆ All Firefighters on scene
- ◆ TPASS-3 EVACUATE Protects You With or Without SCBA

Smart Signal Technology is a patented proprietary high-performance, encrypted two-way radio signaling system that allows every TPASS-3 device to repeat critical distress and evacuate signals. This provides a superior reach and penetration deep into complex building structures assuring these alarm signals are received by Firefighters and the Incident Commander.

Status change events between TPASS-3 and the Command Base LCD-T3 unit are shown on screen automatically. A real-time datalog output is provided and can be captured and stored using a computer or data logger device.

FIREFIGHTER SAFETY With TPASS-3 Evacuate	Signal Direction	ACCOUNTABILITY MONITORING AND CONTROL With COMMAND BASE LCD-T3
Firefighter can send Manual Distress Alarms	■ ■ ■ →	Firefighter Alarm Signals Received by Command LCD-T3 Base.
Automatic "Man-Down" Alarms	■ ■ ■ →	
Auto-on activation via Accountability Key	■ ■ ■ →	Display Registers each individual Firefighter with a TPASS showing their current status.
TPASS-3 receives evacuate Signal	← ■ ■ ■ ← ■ ■ ■ ← ■ ■ ■	Incident Commander initiates EVACUATE order to: Individual Firefighter Group of Firefighters All Firefighters on Scene
Auto-acknowledgement the evacuate signal has been received	■ ■ ■ →	Display confirms TPASS-3 received the evacuate signal
Firefighter manual acknowledgement of evacuate order	■ ■ ■ →	Display confirms Firefighter's awareness of evacuate order Incident Commander may access Snap-Shot Summary Status at any time.

Data Log capability to record with time-stamp all change events sent and received by Base Command Unit in addition to change status events that are normally recorded.

Backwards Compatible, Firefighters with existing TPASS-II (transmit only) will be monitored by the Command Base LCD-T3

Add an EVACUATOR COMMUNICATOR™ to an integrated or existing PASS device to provide a High-Performance Two-Way Radio Telemetry Signaling system compatible with TPASS-3 System for distress and evacuation.

Micro TPASS Repeater is available to enhance system performance in large complex structures or underground facilities.

COMMAND BASE LCD-T3

Total Accountability System with Two-Way Signaling Capability



The Command Base is a portable, user friendly, menu driven control panel and display that provides a real-time status of up to **1100 Firefighters** on the scene, equipped with a TPASS-3.

The Command Base receives, transmits, captures and displays all Alarm signals and continuously monitors and displays the status of each individual Firefighter on scene.

TPASS-3 EVACUATE SYSTEM provides **Total Accountability** automatically registering each TPASS-3 unit present by identifying the individual Firefighter by name and ID number.

A built-in rechargeable battery provides up to 24 hours operation. The Command Base can also be powered by either a 12 volt DC vehicle power or AC power from 90 to 260 volts.

TPASS-3 Alarms received are indicated by Audio Voice Alert, Bright Flashing LED's and the Firefighter's Name is moved automatically to the top position on the display.

A datalog output of all change in status events are automatically time stamped and can be captured and stored to a computer or optional data logging device. The datalog can then be retrieved for future review.

OPTIONAL EQUIPMENT

EVACUATOR COMMUNICATOR™
Designed to work with Integrated SCBA PASS Systems
Contains all the High-Performance, Two-Way Radio Telemetry Signaling capability of the TPASS-3 Evacuate Devices except motion sensing.
Provides Firefighters using Integrated SCBA PASS devices evacuate as alarm independent SCBA!

MICRO TPASS REPEATER™
Compatible with all Grace Industries TPASS Systems.
This portable stand-alone repeater Improves system performance of the TPASS 3 Evacuate and TPASS HP II in high-rise structures and other complex environments such as underground parking garages and subways.

TPASS 3 EVACUATE™

The Only Transmitting and Receiving PASS that CAN BE USED with OR Without SCBA

TPASS-3 EVACUATE is a High-Performance Two-Way Radio Signaling PASS Device that is Intrinsically Safe to UL 913, Independently Tested and Certified.

- ◆ Auto-on Activation using proprietary tethered "Accountability Key" which can be tethered at the Firefighter's Gear storage position and is automatically activated when the Gear is removed to be used.
- ◆ Activation is confirmed by a loud audio sound and flashing LEDs
- ◆ Motion Sensing, via a solid-state accelerometer
- ◆ Temperature Sensing – Optional
- ◆ Manual and Automatic Radio Telemetry Signals from Firefighter to Command Base:



Automatic Signals sent

- Accountability
- "Man-Down" Alarm
- EVACUATION Order Received

Manual Signals sent

- Panic Button for Distress Call
- Acknowledgement of EVACUATE Order

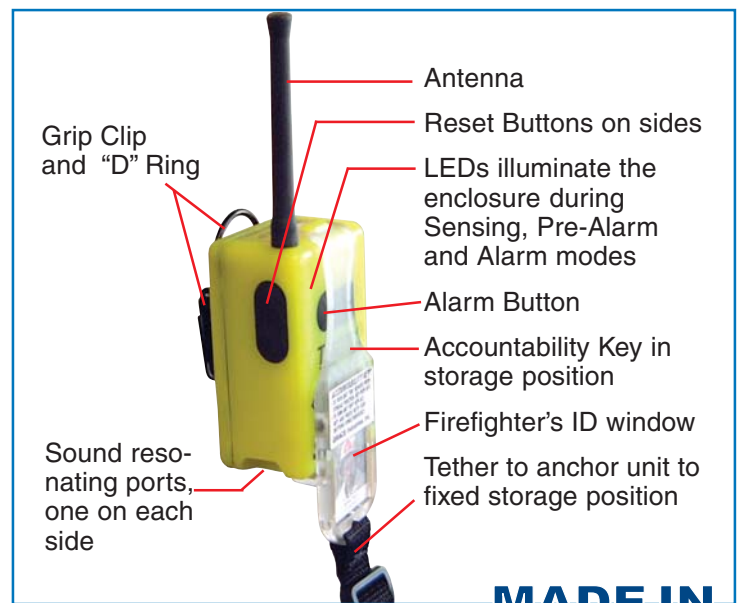

TPASS3 EVACUATE™ 2-WAY SIGNALING SYSTEM

COMMAND BASE LCD-T3

Features and Detailed Specifications	Description
Command Base Screen - Liquid Crystal Display (LCD)	Large back lighted 9-5/8" x 2-3/4" screen - standard
Controls	Sealed Membrane Switching
Voice Recorder – Alarm Indicators	Solid State – Programmable – Voice Message - any language
Data Logging – output	RS232 serial port

EVACUATION Mode

Evacuate - Individual	Select from Command Base Screen
Evacuate - Group	Select from Command Base Screen
Evacuate - All Firefighters	Select from Command Base Screen

ALARM Mode

Immediate Notification of Distress Signal from Firefighter Alarm either Manual or Man-Down mode	High Intensity LED's, playback Voice Message, Name moves to top of list on LCD Screen showing alarm activated
---	---

Auxiliary Panel

DC Power	12V 2-Pin Connector
AC Power	90-260V Universal input switching power supply
Battery Power hours with quick charge and unit off	NiCad, Up to 24 hours continuous run time Rechargeable in 3
Battery Status Lights	Colored LEDs indicate state of charge
Alarm Relay Contacts	5-Pin Connector for Lights or Audio and Telephone dialers, Form C - NO/NC
Enhanced Radio Receiver	9 Pin Connector
RS232 – DB9 Connector	Computer Direct Connection for convenient programming of Names and I.D.s. and provides for Data-logger output

Command Base LCD -T3 - Physical Attributes

Case Dimensions (approximate)	18.5" L x 14.6" W x 5.7" deep. Portable or Stationary
Weight (approximate)	19 lbs.

TPASS-3 EVACUATE

Intrinsically Safe	Certified UL913 for Class 1, Division 1, Group A, B, C and D Hazardous locations.
Auto-On Activation	Propriety Tethered Accountability Key
Motion Sensing	Solid State Accelerometer
High Frequency 2 Way Radio	902-928 MHz No FCC License Required
Smart-Signal Technology - Proprietary	Each TPASS-3 EVACUATE is a Smart Repeater for critical signals providing superior in building performance
TPASS-3 Complete Protection with or without SCBA	Stand alone system for all situations
Automatic Motion Sensing - Man Down Alarm Activation Command Base and indicated on Command Screen	30-35 seconds - Loud Audio Alarm and Alarm signal to
Manual Mode Alarm Activation (Panic Button)	Manual Push Button-Need Emergency Assistance
Receive Evacuation Signals	Initiated from Command Base
Evacuation – Dual Indicators	Audio and Visual, Loud Alarm and Flashing LEDs (1 Red LED on top and two yellow LEDs on front)
Confirmation of TPASS-3 Active	Visible Flashing LED lights
Check-in Status Signal	Periodic signal sent to Command Base
Temperature Sensing – Alarm	Optional

TPASS-3 EVACUATE - Physical Attributes

Dimensions (approximate)	Compact Size 2" W, 3-1/8" H, 1-1/2" deep
Weight (approximate)	8 oz. With Battery and W/O Accountability Key
Low Battery Alarm	Alarm @ 20% capacity (1 hr. minimum in alarm mode remaining)
Battery	9 volt Duracell MN 1604 recommended and included
Battery Life (approximate)	30 hours In Sensing Mode and 2-4 hours in Alarm Mode



TPASS-3 Evacuate™

A 2-WAY PASS
 SIGNALING
 SYSTEM WITH
 ADVANCED
 ACCOUNTABILITY

1-800-969-9231
724-962-9231

www.graceindustries.com

QUALITY SYSTEM
 REGISTERED TO
 ISO 9001-2000

TPASS 3 EVACUATE™

A 2-WAY PASS SIGNALING SYSTEM **MADE IN USA**
 with ADVANCED ACCOUNTABILITY

